

related literature | visit <http://www.corning.com/opcomm/>

003-794

Instruction, EDGE™ Solution

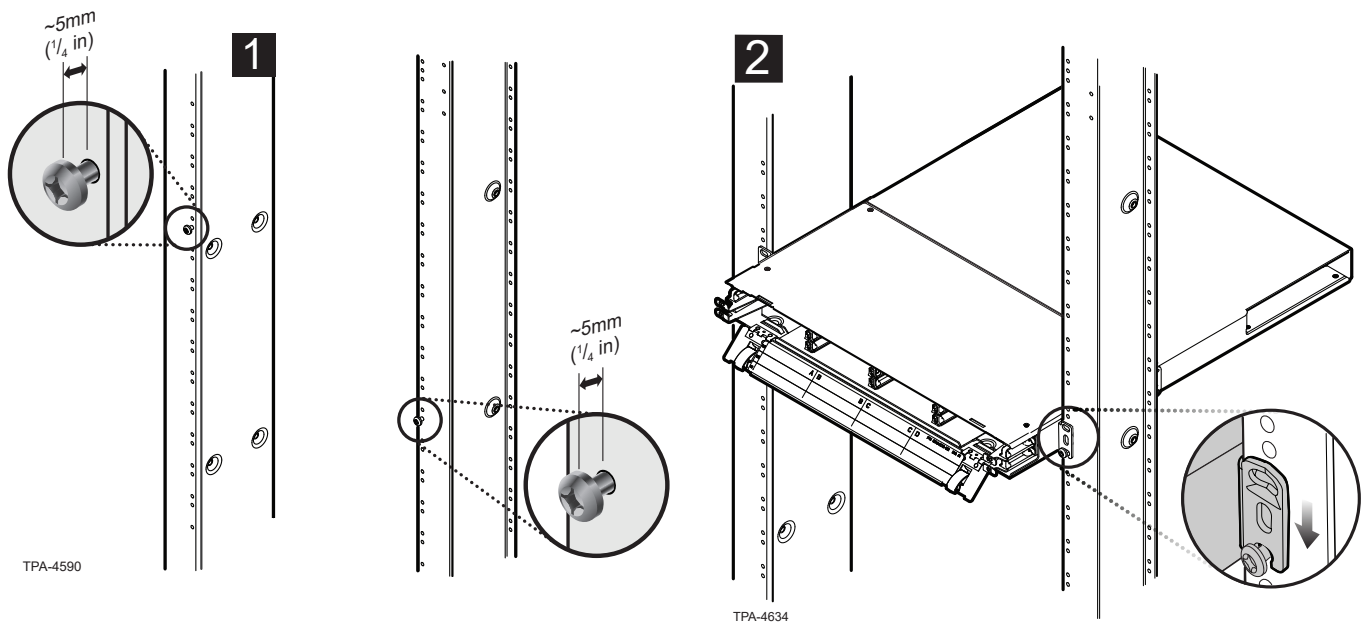

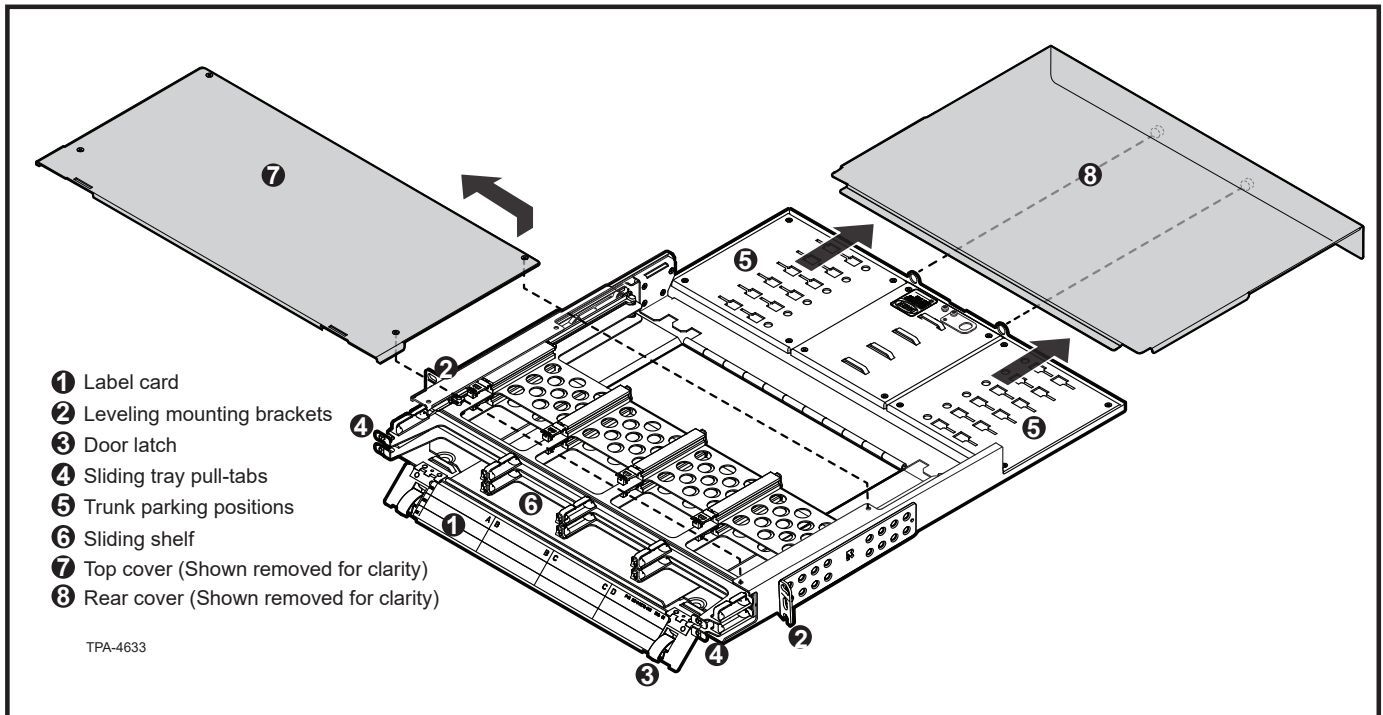
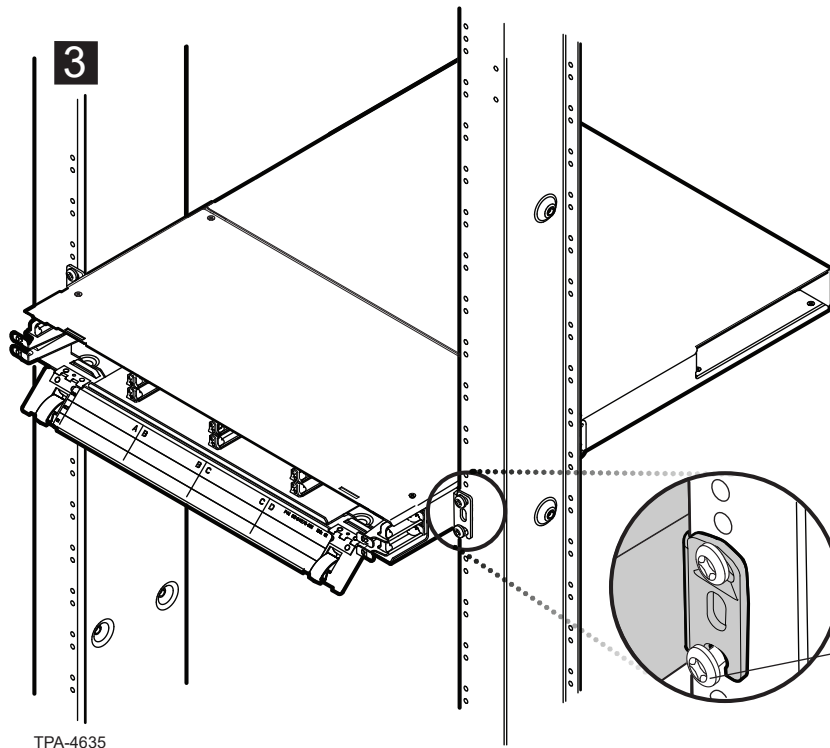

3

NOTE: Use this screw to optimize housing's level.

TPA-4635

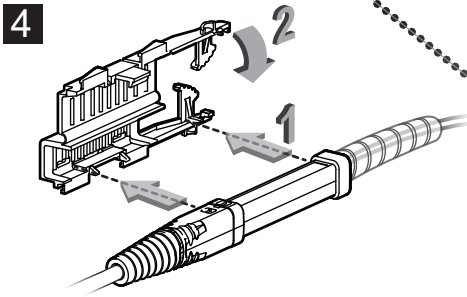

4

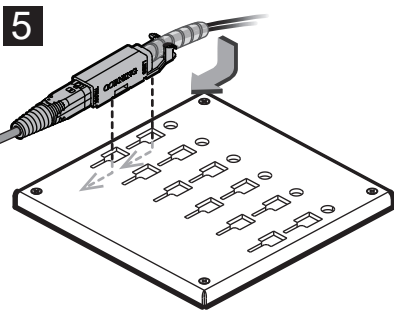

5

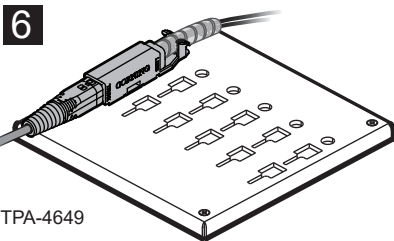

6

TPA-4649

7

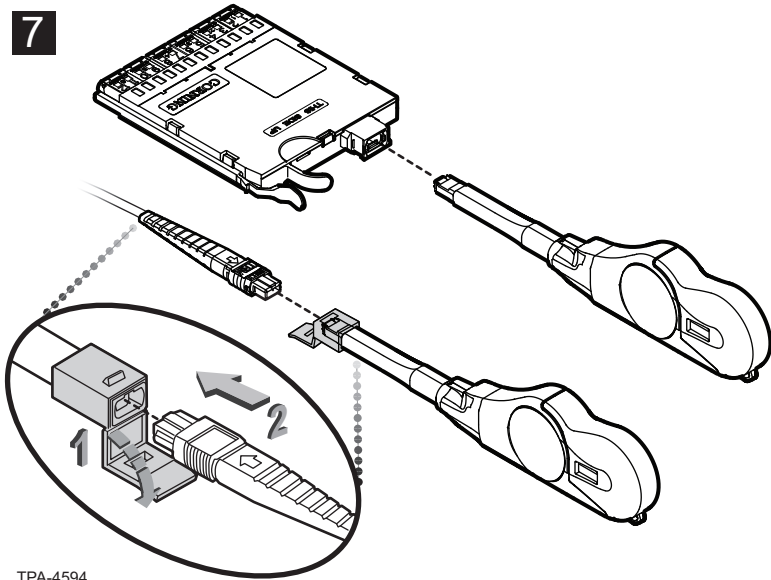

TPA-4594

8

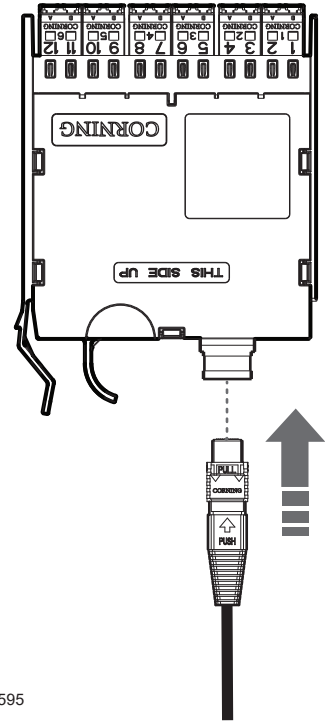

TPA-4595

9

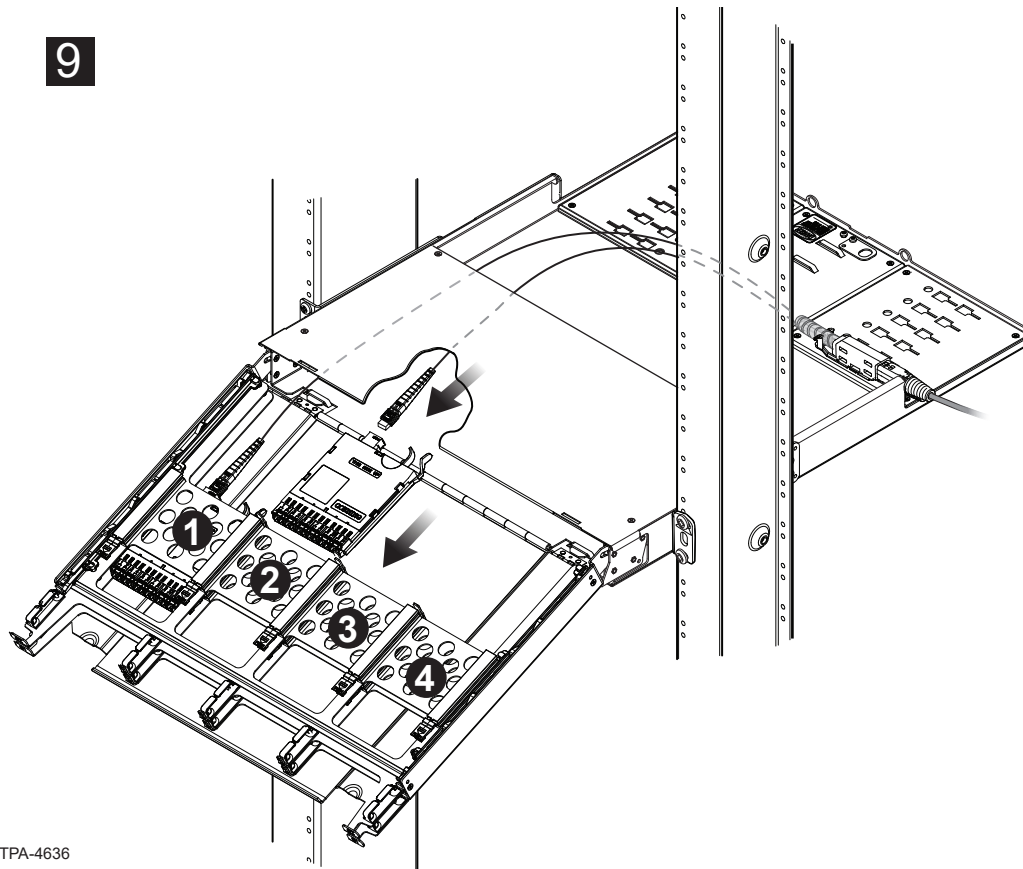

TPA-4636

10

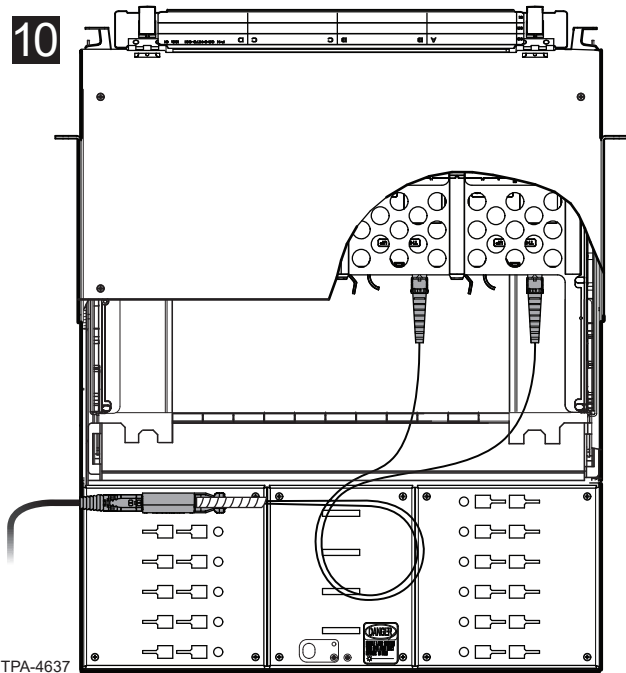

11

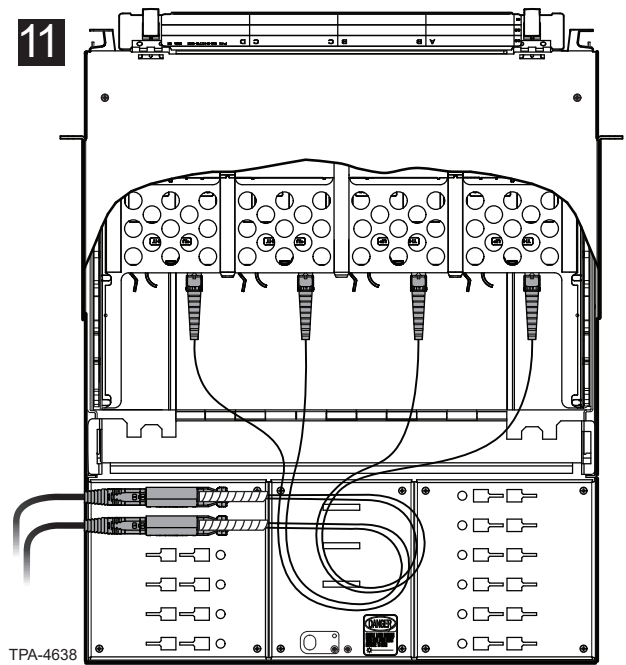

12

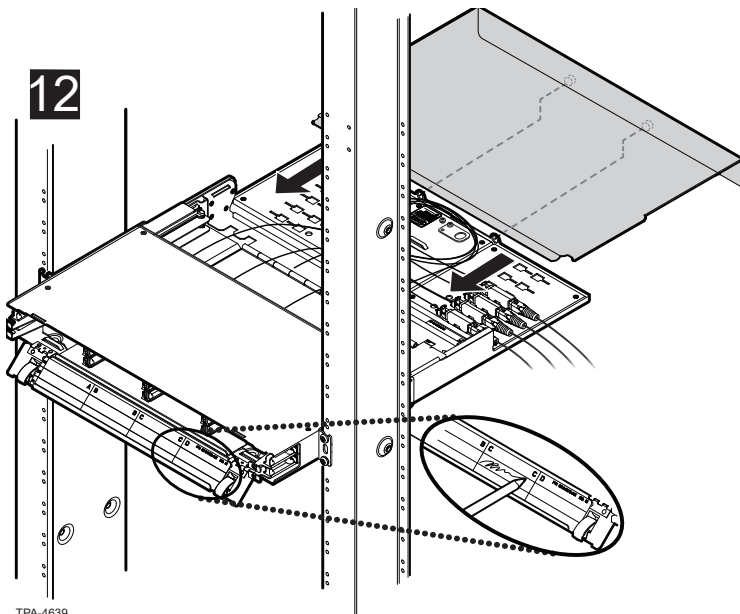

13

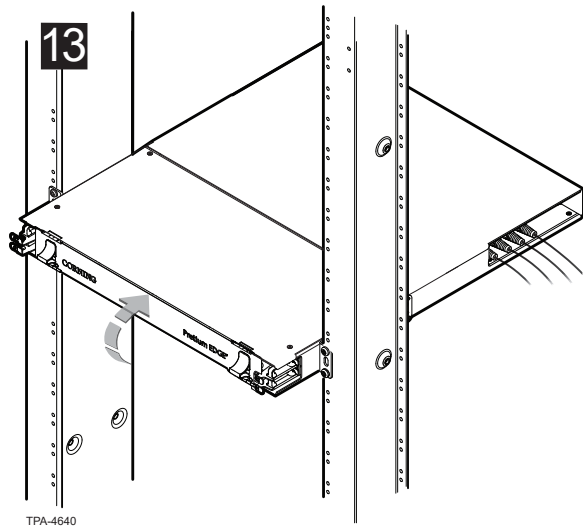

Corning Optical Communications LLC • 4200 Corning Place • Charlotte, NC 28216 USA
 800-743-2675 • FAX: 828-325-5060 • International: +1-828-901-5000 • www.corning.com/opcomm

Corning Optical Communications reserves the right to improve, enhance, and modify the features and specifications of Corning Optical Communications products without prior notification. A complete listing of the trademarks of Corning Optical Communications is available at www.corning.com/opcomm/trademarks. All other trademarks are the properties of their respective owners. Corning Optical Communications is ISO 9001 certified. © 2014, 2018, 2022 Corning Optical Communications. All rights reserved.